



0.25" 1050 °C

Specifications:

Temperature Range:	50 – 1050 C
Emittance Watts/Cm ² (Watts):	17.36 (5.5)
Wavelength Range:	0.5 - 99um
Emissivity:	>0.99
Emitter Size: in (mm)	0.25" (6.3)
Source Type:	Cavity
Temperature Resolution:	0.1 C
Calibration Accuracy:	+/- 0.2 C to NIST Standard
Stability: Short (Long) Term:	+/- 0.1 C (+/- 0.2C)
Response Time:	100-1000 <30 Minutes
Temperature Sensors:	Embedded 0.01% Matched Type S
Control Type:	Active Multi-Band P.I.D.
Line Voltage:	90 to 125 or 208-240 VAC 50-60 Hz
Power Requirements:	100 Watts Max
Cable Length:	8 Feet (2.4 m)
Dimensions: in (mm)	Source: 3" Diam x 5.9" H x 4.9" D (76.2x150x125)
	Controller: 5.1"H x 13.4"D x 12"W (130x340x304)
	Warranty: 2 Year
Standard Apertures:	0.1" (2.54)
Remote Interface:	RS-232, RS-485 or IEEE-488/GPIB

OPTIONS AND ADDITIONAL ACCESSORIES:

- ~ Aperture Wheel with Aperture sizes:
0.200", 0.100", 0.050", 0.0250", 0.0125"
- ~ IR-762 Energy Modulator
- ~ RS232 and IEEE/GPIB Communications

IR-508/301 DIMENSIONS

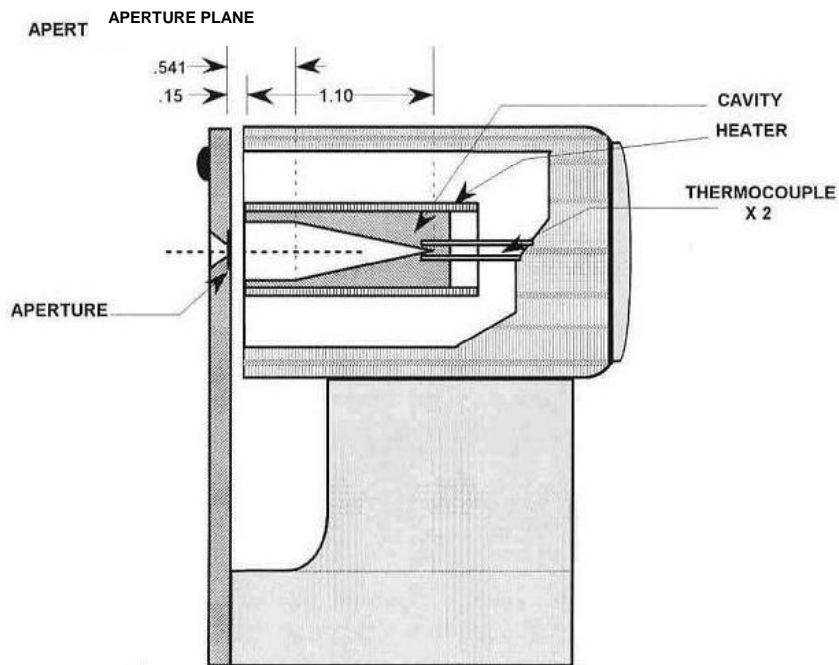
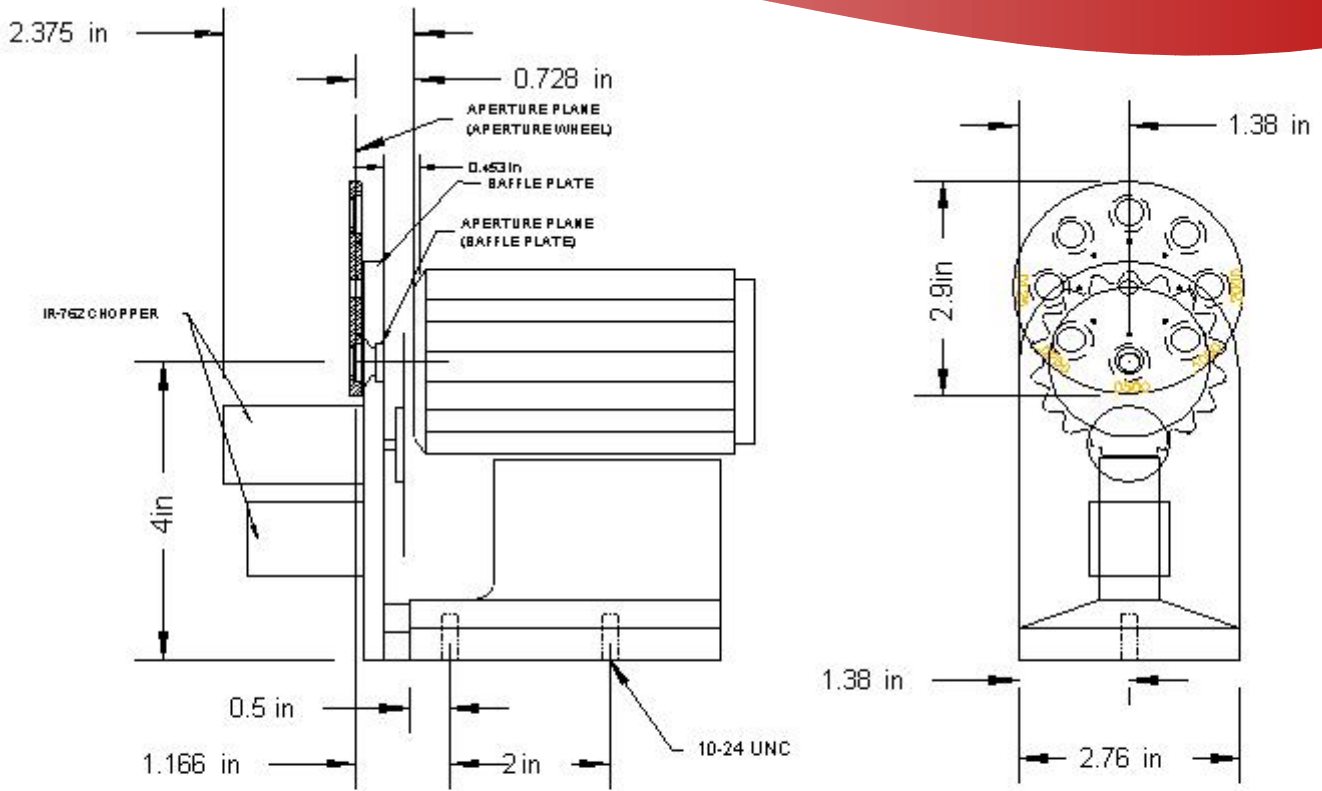



0.40"
1050 °C

Specifications:

Temperature Range: 50 – 1050 C
Emittance Watts/Cm² (Watts): 17.36 (14)
Wavelength Range: 0.5 - 99um
Emissivity: >0.99
Emitter Size: in (mm) 0.4" (10)
Source Type: Cavity
Temperature Resolution: 0.1 C
Calibration Accuracy: +/- 0.2 C to NIST Standard
Stability: Short (Long) Term: +/- 0.1 C (+/- 0.2C)
Response Time: 100-100 <40 Minutes
Temperature Sensors: Embedded 0.01% Matched Type S
Control Type: Active Multi-Band P.I.D.
Line Voltage: 90 to 125 or 208-240 VAC 50-60 Hz
Power Requirements: 100 Watts Max
Cable Length: 8 Feet (2.4 m)
Dimensions: in (mm) **Source:** 2.375" Diam x 3" Deep(60 x 76.2)
Controller: 5.1"H x 13.4"D x 12"W (130x340x304)
Warranty: 1 Year
Standard Apertures: 0.4" (10)
Remote Interface: RS-232, RS-485 or IEEE-488/GPIB

OPTIONS AND ADDITIONAL ACCESSORIES:

- ~ Baffle Plate / Mounting Black (shown above)
- ~ IR-762 Energy Modulator
- ~ RS232 and IEEE/GPIB Communications

IR-518/301 DIMENSIONS

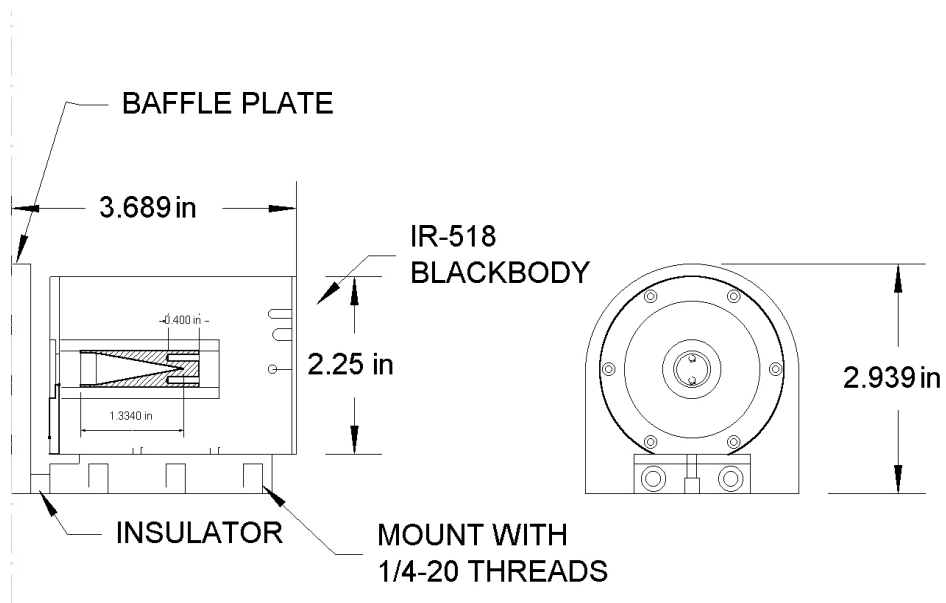
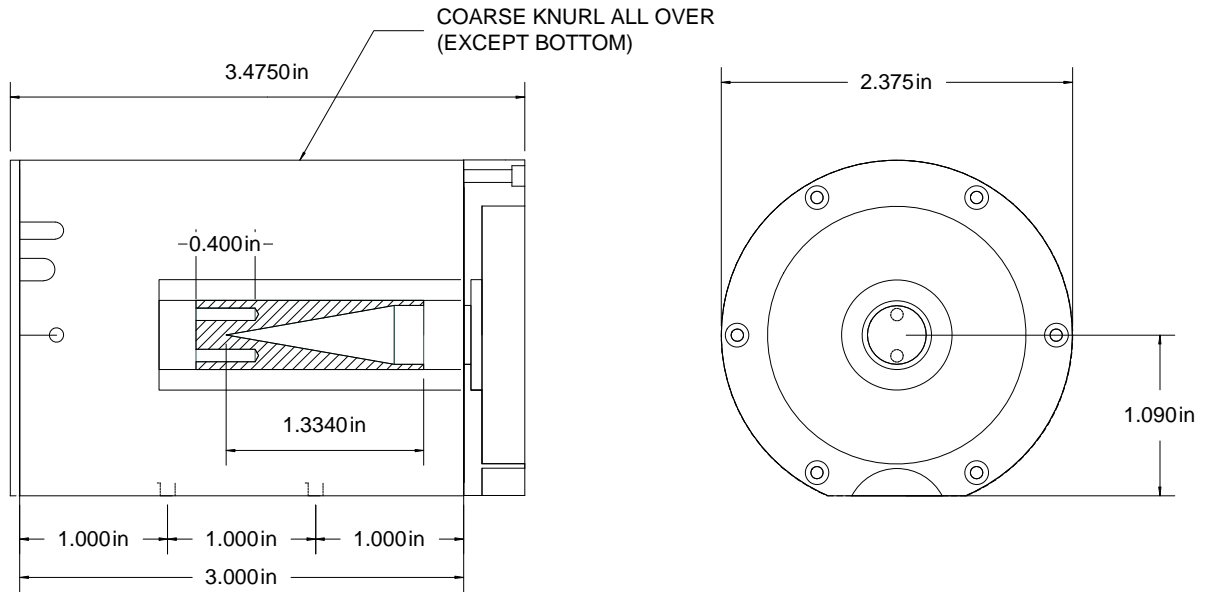

WITH BAFFLE PLATE AND MOUNTING BLOCK



0.40"
1200 °C

Specifications:

Temperature Range: 50 – 1200 C
Emittance Watts/Cm² (Watts): 17.36 (14)
Wavelength Range: 0.5 - 99um
Emissivity: >0.99
Emitter Size: in (mm) 0.4" (10)
Source Type: Cavity
Temperature Resolution: 0.1 C
Calibration Accuracy: +/- 0.2 C to NIST Standard
Stability: Short (Long) Term: +/- 0.1 C (+/- 0.2C)
Response Time: 100-1200 <45 Minutes
Temperature Sensors: Embedded 0.01% Matched Type S
Control Type: Active Multi-Band P.I.D.
Line Voltage: 90 to 125 or 208-240 VAC 50-60 Hz
Power Requirements: 100 Watts Max
Cable Length: 8 Feet (2.4 m)
Dimensions: in (mm) **Source:** 2.375" Diam x 4" Deep(60 x 101.6)
Controller: 5.1"H x 13.4"D x 12"W (130x340x304)
Warranty: 1 Year
Standard Apertures: 0.4" (10)
Remote Interface: RS-232 or IEEE-488/GPIB

OPTIONS AND ADDITIONAL ACCESSORIES:

- ~ Baffle Plate / Mounting Black (shown above)
- ~ IR-762 Energy Modulator
- ~ RS232 and IEEE/GPIB Communications

IR-519/301 DIMENSIONS

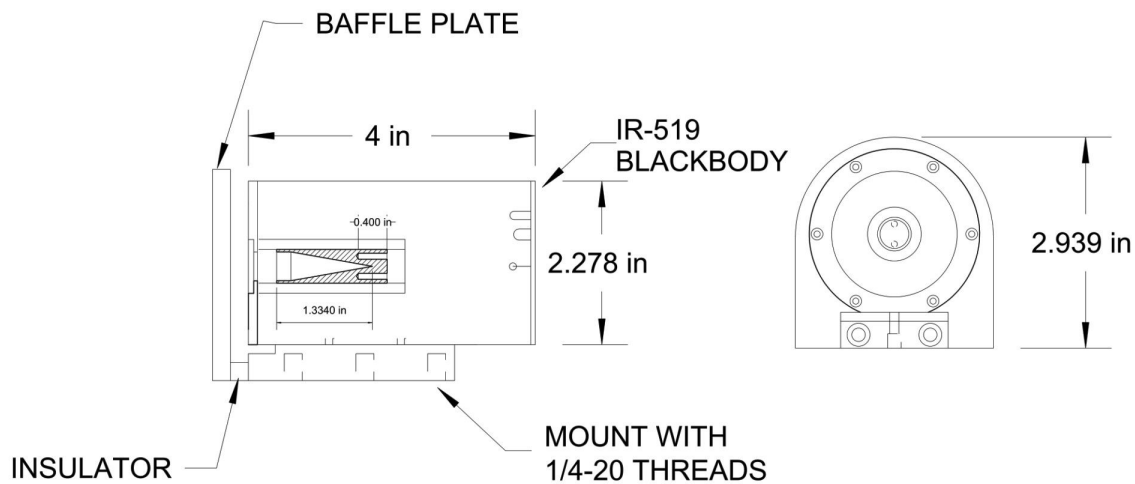
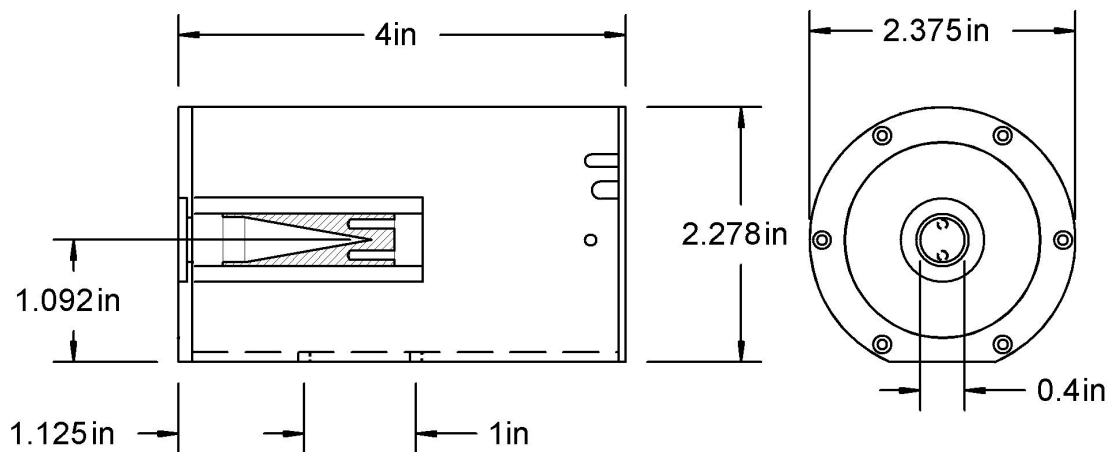

WITH BAFFLE PLATE AND MOUNTING BLOCK



1.0"
1050 °C

Specifications:

Temperature Range:	50 – 1050 C
Emittance Watts/Cm² (Watts):	17.36 (88)
Wavelength Range:	0.5 - 99um
Emissivity:	>0.99
Emitter Size: in (mm)	1" (25.4)
Source Type:	Cavity
Temperature Resolution:	0.1 C
Calibration Accuracy:	+/- 0.2 C to NIST Standard
Stability: Short (Long) Term:	+/- 0.1 C (+/- 0.2C)
Response Time:	100-1000 <45 Minutes
Temperature Sensors:	Embedded 0.01% Matched Type S
Control Type:	Active Multi-Band P.I.D.
Line Voltage:	90 to 125 or 208-240 VAC 50-60 Hz
Power Requirements:	550 Watts Max
Cable Length:	8 Feet (2.4 m)
Dimensions: in (mm)	Source: 11.75" H x 11.4" D x 8" W (298x289x203)
	Controller: 5.1"H x 13.4"D x 12"W (130x340x304)
	Warranty: 2 Year
	Standard Apertures: 0.125, 0.025, 0.050, 0.10, 0.20, 0.40, 0.60 and 1.0 In
	Remote Interface: RS-232, RS-485 or IEEE-488/GPIB

OPTIONS AND ADDITIONAL ACCESSORIES:

- ~ IR-860 Energy Modulator
- ~ RS232 and IEEE/GPIB Communications
- ~ 1" Remote Control Motorized Indexed Aperture Wheel

IR-563/301 DIMENSIONS

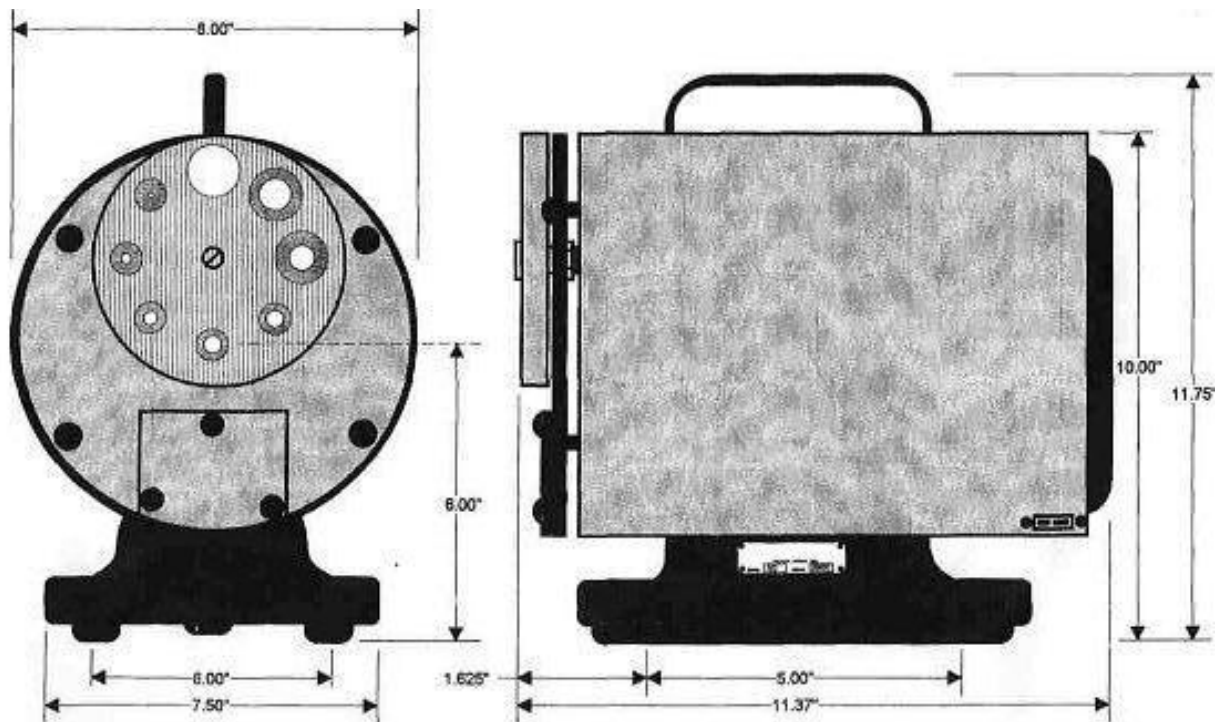
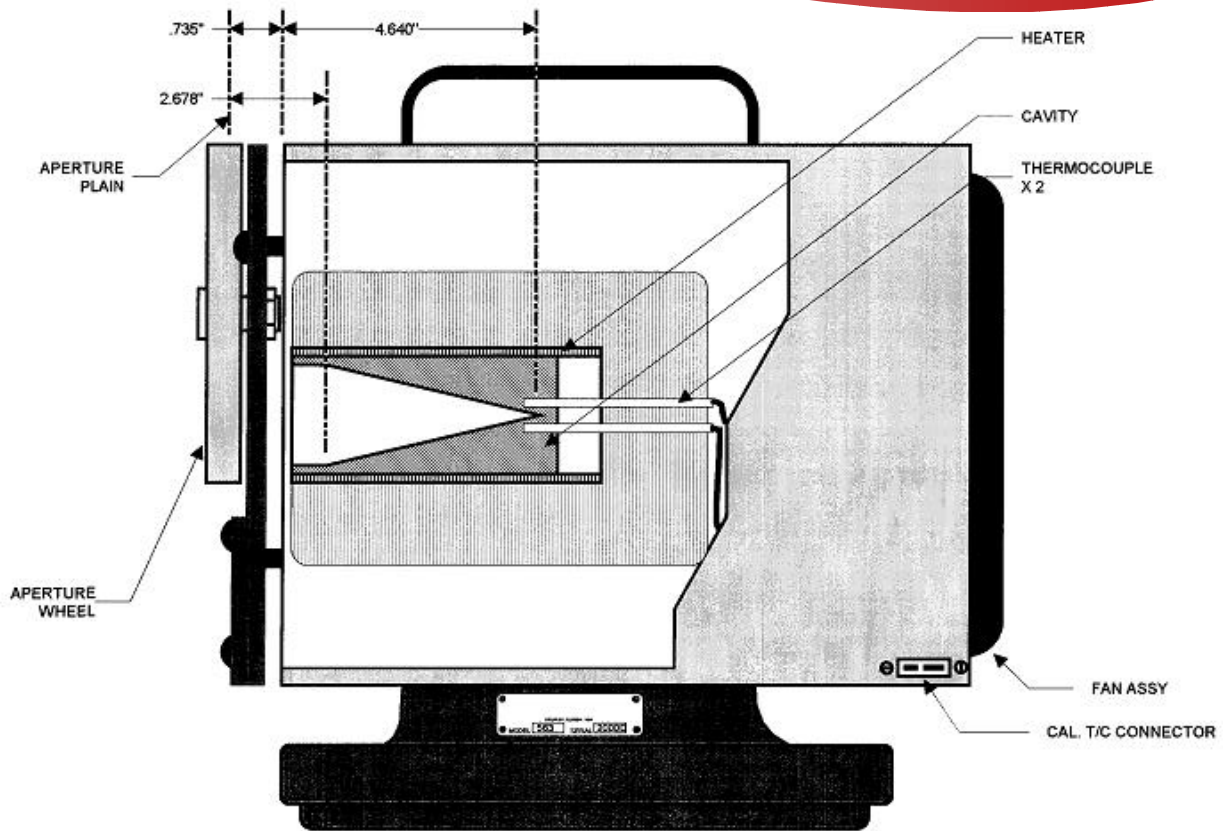

7319 SANDSCOVE CT. #4 Φ WINTER PARK, FL 32792

(TEL) 407-679-5101 Φ (FAX) 407-679-5520

SALES@INFRAREDSYSTEMS.COM [HTTP://WWW.INFRAREDSYSTEMS.COM](http://WWW.INFRAREDSYSTEMS.COM)



1.0"
1200 °C

Specifications:

Temperature Range:	50 – 1200 C
Emittance Watts/Cm ² (Watts):	26.68 (135)
Wavelength Range:	0.5 - 99um
Emissivity:	>0.99
Emitter Size: in (mm)	1" (25.4)
Source Type:	Cavity
Temperature Resolution:	0.1 C
Calibration Accuracy:	+/- 0.2 C to NIST Standard
Stability: Short (Long) Term:	+/- 0.1 C (+/- 0.2C)
Response Time:	100-1200 <70 Minutes
Temperature Sensors:	Embedded 0.01% Matched Type S
Control Type:	Active Multi-Band P.I.D.
Line Voltage:	90 to 125 or 208-240 VAC 50-60 Hz
Power Requirements:	800 Watts Max
Cable Length:	8 Feet (2.4 m)
Dimensions: in (mm)	Source: 11.75" H x 11.4" D x 8" W (298x289x203)
	Controller: 5.1"H x 13.4"D x 12"W (130x340x304)
	Warranty: 1 Year
Standard Apertures:	0.125, 0.025, 0.050, 0.10, 0.20, 0.40, 0.60 and 1.0 In
Remote Interface:	RS-232, RS-485 or IEEE-488/GPIB

OPTIONS AND ADDITIONAL ACCESSORIES:

- ~ IR-860 Energy Modulator
- ~ RS232 and IEEE/GPIB Communications
- ~ 1" Remote Control Motorized Indexed Aperture Wheel

IR-564/301 DIMENSIONS

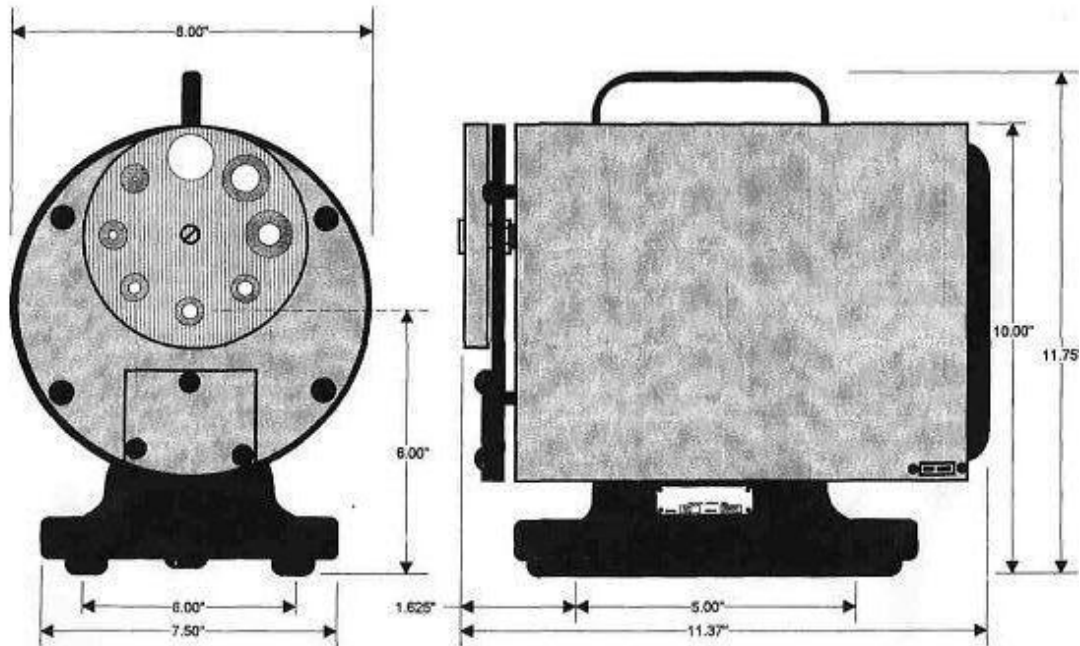
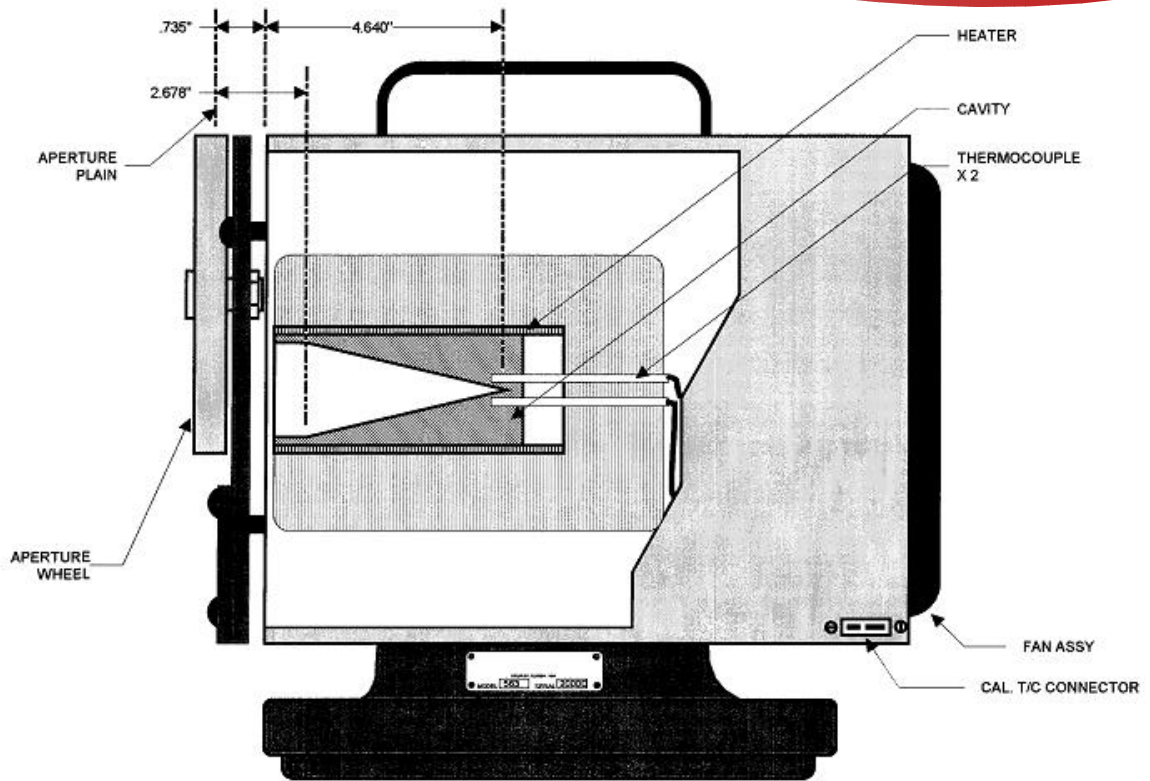

7319 SANDSCOVE CT. #4 Φ WINTER PARK, FL 32792

(TEL) 407-679-5101 Φ (FAX) 407-679-5520

SALES@INFRAREDSYSTEMS.COM [HTTP://WWW.INFRAREDSYSTEMS.COM](http://WWW.INFRAREDSYSTEMS.COM)

IR-574/301

CAVITY BLACKBODY



2.25" 1200 °C

Specifications:

Temperature Range: 50 – 1200 C
Emittance Watts/Cm² (Watts): 26.68 (684)
Wavelength Range: 0.5 - 99um
Emissivity: >0.99
Emitter Size: in (mm) 2.25" (57)
Source Type: Cavity
Temperature Resolution: 0.1 C
Calibration Accuracy: +/- 0.2 C to NIST Standard
Stability: Short (Long) Term: +/- 0.1 C (+/- 0.2C)
Response Time: 100-1200 <80 Minutes
Temperature Sensors: Embedded 0.01% Matched Type S
Control Type: Active Multi-Band P.I.D.
Line Voltage: 90 to 125 or 208-240 VAC 50-60 Hz
Power Requirements: 1400 Watts Max
Cable Length: 8 Feet (2.4 m)
Dimensions: in (mm) **Source:** 12.5" H x 20" D x 10" W (317x508x254)
Controller: 5.1"H x 13.4"D x 12"W (130x340x304)
Warranty: 1 Year
Standard Apertures: 2.0" (50.8)
Remote Interface: RS-232, RS-485 or IEEE-488/GPIB

OPTIONS AND ADDITIONAL ACCESSORIES:

~ 2" Remote Control Motorized Indexed Aperture Wheel
~2" Apertures
~RS232 and IEEE/GPIB Communications

7319 SANDSCOVE CT. #4 Φ WINTER PARK, FL 32792
(TEL) 407-679-5101 Φ (FAX) 407-679-5520

SALES@INFRAREDSYSTEMS.COM [HTTP://WWW.INFRAREDSYSTEMS.COM](http://WWW.INFRAREDSYSTEMS.COM)

IR-574/301 DIMENSIONS

